

DOC SERIES

SUBMERSIBLE PUMPS

DOC pumps are versatile, corrosion-resistant and compact. Three basic versions are available with 0.3 to 0.7 kW power.

A DOC 7VX version with Vortex impeller is available.

APPLICATIONS

- Emptying of residential sump pits, rainwater tanks or laundry drainage.
- Garden and lawn irrigation, with suction from rainwater tanks.
- Emergency draining of flooded basements and garages.
- Transfer of water from tanks, cisterns and swimming pools.
- Water display, fountains.

SPECIFICATIONS

- Maximum liquid temperature: 40°C with partially submerged pump.
- Dry motor.
- Maximum immersion depth: 5 m.
- Class B insulation.
- IP 68 protection.
- The DOC 3 pump has a delivery of 145 l/min, head up to 7 m, and passes suspended solids up to 10 mm in diameter. Only available in single-phase version.
- The DOC 7 pump has a delivery of 225 l/min, head up to 11 m, and passes suspended solids up to 10 mm in diameter.
- The DOC 7VX pump has a delivery of 180 l/min, head up to 7 m, and can handle liquids with suspended solids up to 20 mm in diameter.
- A "shallow-suction device", that can be mounted on both the DOC3 and DOC7 models, is available on request. It ensures complete drainage of flooded floors (to 3 mm from floor).
- Versions:
Single-phase 220 V 50 Hz 2 poles (2850 rpm).
Three-phase 380-415 V 50 Hz 2 poles (2850 rpm).
- 60 Hz and without floats (SG) models are available on request or tube float switch.



- The single-phase versions feature:
Pre-assembled float for automatic pump operation (version without float available on request SG).
Built-in capacitor.
Thermal overload protection to stop pump supply in case of overheating.

LAB-LIP SEAL SYSTEM

- The electric motor is protected by **three lip seals**.
 An **impeller counterblade** system keeps solid particles away from the seal unit to prevent damage to the lip seals and ensure their long-lasting efficiency. A double **Labyrinth** and a **V-ring** on the shaft have also been provided.

TABLE OF MATERIALS

PART	MATERIAL
Pump body, Suction screen, Handle, Upper support, Impeller	NORYL TECHNO POLYMER
Outer sleeve, Motor casing, Lower cover, Screws and tie-rods	STAINLESS STEEL (AISI 304 - DIN 1.4301)
Shaft extension	STAINLESS STEEL (AISI 416 - DIN 1.4005)
Elastomers	NITRILE RUBBER (NBR)

DOC SERIES
OPERATING CHARACTERISTICS AT 2850 rpm 50 Hz

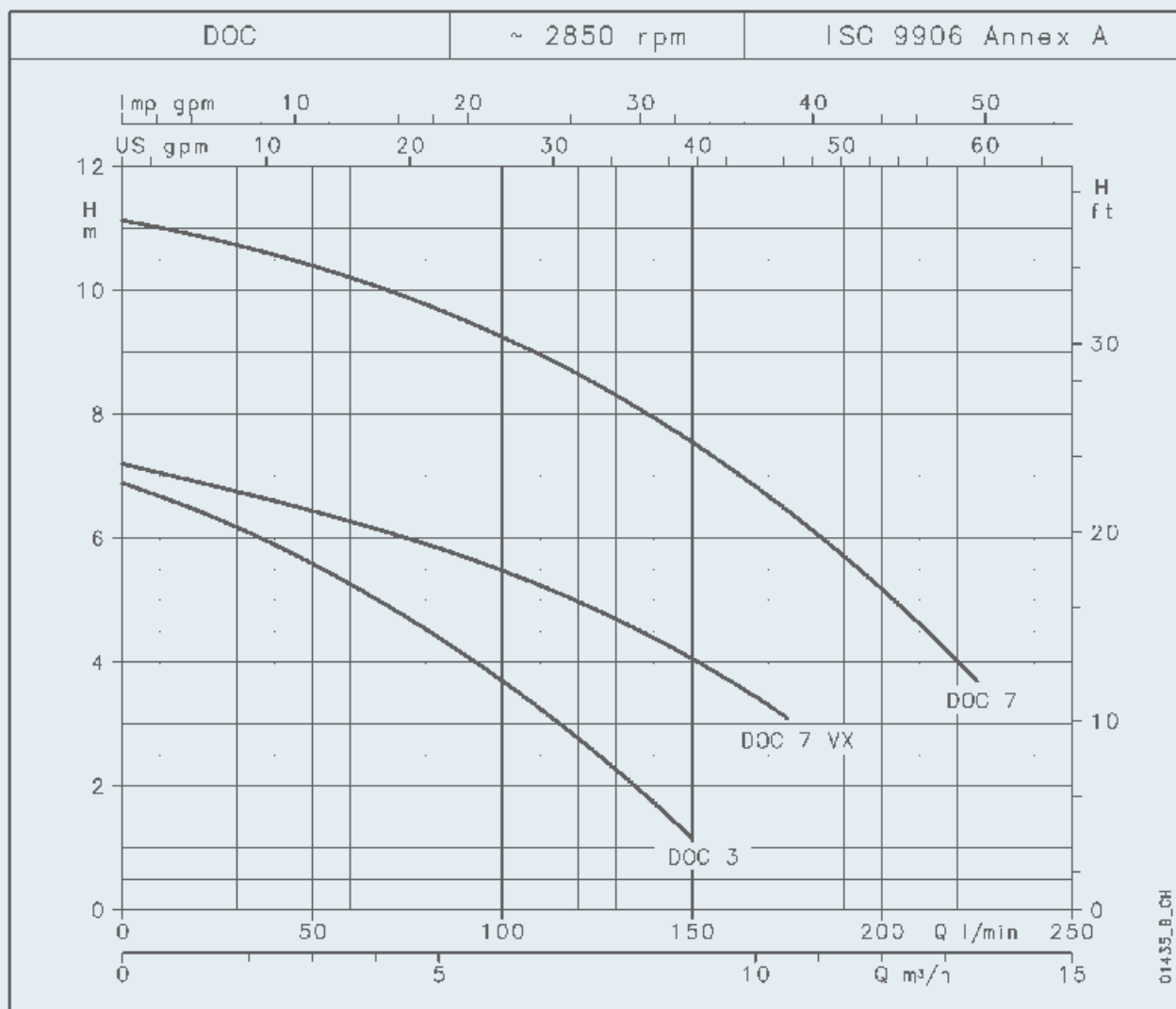

PUMP TYPE	RATED POWER		Q = DELIVERY								
			l/min	0	25	50	75	100	125	150	175
	m3/h	0	1.5	3	4.5	6	7.5	9	10.5	13.5	
	H = TOTAL HEAD METERS COLUMN OF WATER										
DOC3	0.25	0.33	6.9	6.3	5.6	4.7	3.7	2.5	1.2		
DOC7(T)	0.55	0.75	11.1	10.8	10.4	9.9	9.3	8.5	7.6	6.5	3.7
DOC7VX(T)	0.55	0.75	7.2	6.8	6.4	6.0	5.5	4.8	4.1	3.1	

These performances are valid for liquids with density $\rho = 1.0 \text{ kg/dm}^3$ and kinematic viscosity $\nu = 1 \text{ mm}^2/\text{sec}$.

p50_a_th

PUMP TYPE	INPUT POWER*	INPUT CURRENT*	CAPACITOR
SINGLE-PHASE		220-240 V	
	kW	A	$\mu\text{F} / 450 \text{ V}_{\text{K}}$
DOC 3	0.31	1.43	6.3
DOC 7	0.78	3.47	16
DOC 7VX	0.66	2.96	16

*Maximum value in specified range

PUMP TYPE	INPUT POWER*	INPUT CURRENT*	INPUT CURRENT*
THREE-PHASE		220-240 V	380-415 V
	kW	A	A
-	-	-	-
DOC 7T	0.79	2.82	1.63
DOC 7VXT	0.66	2.68	1.55

doc-2p50_a_th

INSTALLATION DIAGRAM

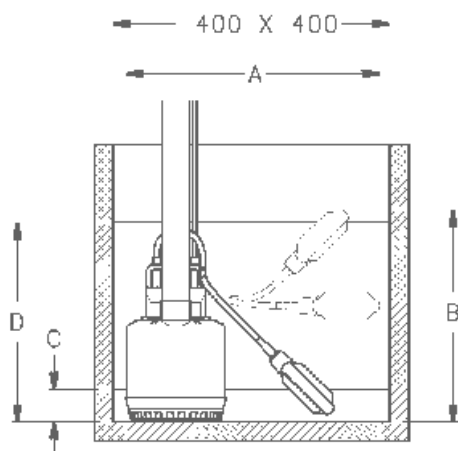

PUMP TYPE	DIMENSIONS (mm)		MINIMUM WATER LEVEL	MAXIMUM WATER LEVEL
	A	B		
DOC3	390	330	50	310
DOC7	390	370	90	350
DOC7VX	390	395	115	375

docliv-2p50_a_td

01446_B_DD



This float switch allows the pump to be used where standard float design cannot work due to insufficient space. The pump with this system can only be installed vertically and can only be used with clean water.

For pump installations that use the tube float switch, the level of start and stop are fixed, therefore they cannot be modified.

DOC SERIES DIMENSIONS AND WEIGHTS

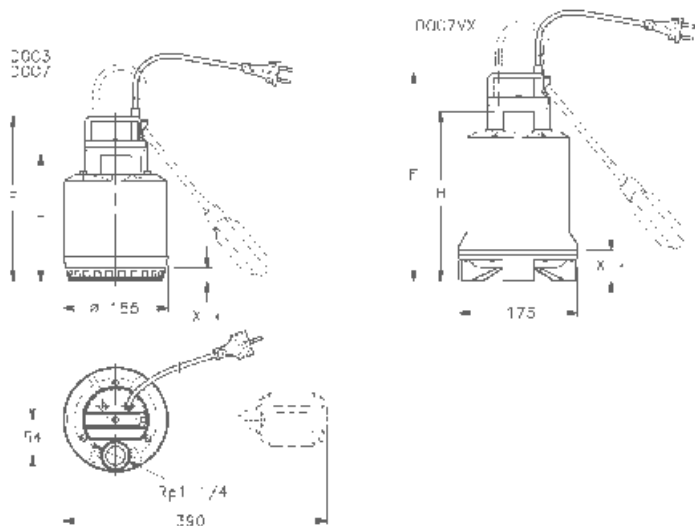

PUMP TYPE	DIMENSIONS (mm)			WEIGHT
	F	H	X*	
DOC3	245	188	20	4
DOC7(T)	285	228	20	6
DOC7VX(T)	310	252	45	6

*Minimum liquid level

doc-2p50_a_td

01433_B_DD

ACCESSORIES

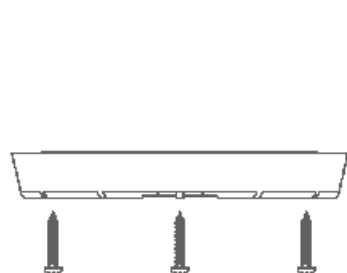

Lower suction device

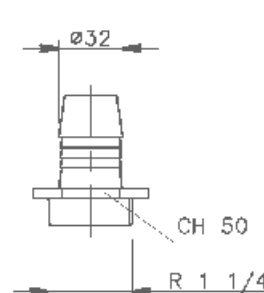
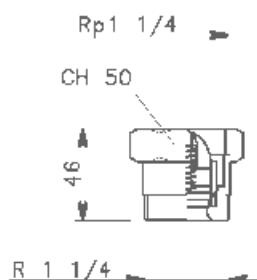

01446_B_DD

XYLEM is a leader in efficient, sustainable water technologies and applications. With 12,000 employees in more than 150 countries, Xylem is committed to serve municipal water, wastewater, residential and commercial building services and industrial markets; Xylem is focused on one of the world's biggest issues - water.

Our Value Centers serve the world.

Water Solutions provides wastewater and dewatering pumps, biologic treatments, and filtration and disinfection products for municipal and industrial use

Residential and Commercial Water supports the efficient movement and use of water in homes, commercial buildings, and agriculture and irrigation.

Analytics manufactures premium laboratory, field, portable, and online instruments for precise measurement, serving industries from environmental to education.

Flow Control offers versatile industrial-grade low-flow pumps and engineered valves, with highly engineered components that stand up to harsh environments where the cost of failure is high.



Xylem Water Solutions India Pvt.Ltd.

India Head Office
Plot no. 21, 2nd Floor,
Prana House, Walbhat Road
Cama Estate, Goregaon (E)
Mumbai - 400063
Tel : +91 22 6784 3000
Fax : +91 22 6784 3033

Registered Office & Factory
Plot No.731, GIDC Savli
Manjusa, Savli Road
Vadodara - 391770
Tel : +91 2667 265 700
Fax : +91 2667 265 764

Delhi Office
H-20, Bali Nagar
New Delhi - 110015
Tel : +91 11 4555 2806
Fax : +91 11 2519 5007

Bengaluru Office
No. 7, Kumara Park East
Kumara Park East Extension
Bengaluru - 560020
Tel : +91 80 4281 6800
Fax: +91 80 4281 6801

Chennai Office
Ghatala Towers, 1st floor
19, Avenue Road
Nungambakkam
Chennai - 600034
Tel: +91 44 4043 5555
Fax: +91 44 4043 5550

www.xylemindia.in

Email : indiasales@xyleminc.com, indiaservice@xyleminc.com